

30 SERIES

G-1315
Balok



PRODUCT INFORMATION

 [Download Files](#)

 [Colour Scheme](#)

 [3D Render](#)

 SUITABLE FOR EXTREME MARINE

 [Extreme Marine](#)

PLAY VALUE



 x 7
ACTIVITIES

 x 9
USERS

SPECIFICATIONS

Age Range	Junior/Mixed
Fall Height	1200mm
Soft-fall Area	47.2m ²
Space Req. Incl Soft-fall	8.50m x 7.30m

TECHNICAL INFORMATION

AUS Standards Compliance	AS4685
Assembly Time	14 Hours
Total Weight	788kg
Heaviest Component	68kg
Concrete Required	3.4m ³
Number of Footings	20

TOP VIEW

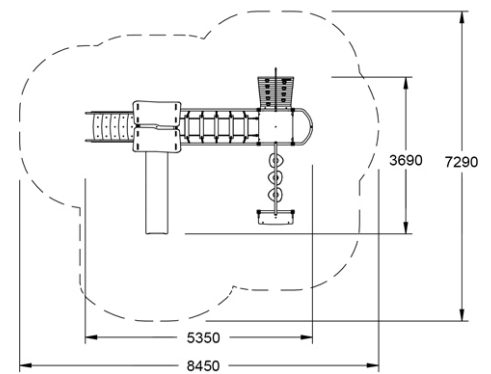

SIDE ELEVATION

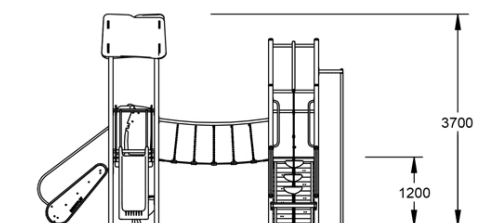

[WARRANTY](#)



[CARE PLAN](#)



[COMPLIANCE](#)



[AUS MADE](#)

