

# SPECTRA

**K-9751**  
Spectra Zenith



## PRODUCT INFORMATION



[Download Files](#)



[3D Render](#)



SUITABLE FOR EXTREME MARINE



[Extreme Marine](#)

## PLAY VALUE



STRENGTH



AGILITY



CLIMB



COORDINATION



SOCIAL PLAY



x 5  
ACTIVITIES



x 10  
USERS

## SPECIFICATIONS

Age Range	Mixed / Primary
Fall Height	1900mm
Soft-fall Area	38.8 m <sup>2</sup>
Space Req. Incl Soft-fall	7m x 8.3m

## TECHNICAL INFORMATION

AUS Standards Compliance	AS4685
Assembly Time	1 Day
Total Weight	776 kg
Heaviest Component	63 kg
Concrete Required	1m <sup>3</sup>
Number of Footings	12

## TOP VIEW

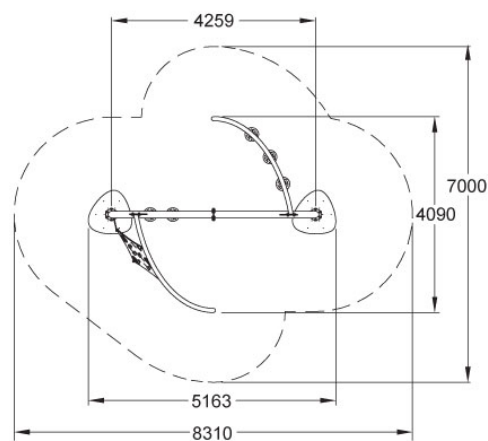

## SIDE ELEVATION

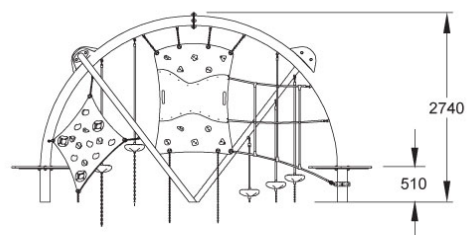

[WARRANTY](#)



[CARE PLAN](#)



[COMPLIANCE](#)



[AUS MADE](#)