

# 30 SERIES

**G-1313**  
Gunyah



## PRODUCT INFORMATION



[Download Files](#)



[Colour Scheme](#)



[3D Render](#)



SUITABLE FOR EXTREME MARINE



[Extreme Marine](#)

## PLAY VALUE



CLIMB



SLIDE



STRENGTH



SOCIAL PLAY



SENSORY



ROLE PLAY



x 11  
ACTIVITIES



x 13  
USERS

## SPECIFICATIONS

Age Range	Junior / Mixed
Fall Height	2150mm
Soft-fall Area	45 m <sup>2</sup>
Space Req. Incl Soft-fall	8.7m x 8.6m

## TECHNICAL INFORMATION

AUS Standards Compliance	AS4685
Assembly Time	12 hours
Total Weight	732 kg
Heaviest Component	39 kg
Concrete Required	2.6 m <sup>3</sup>
Number of Footings	15

## TOP VIEW

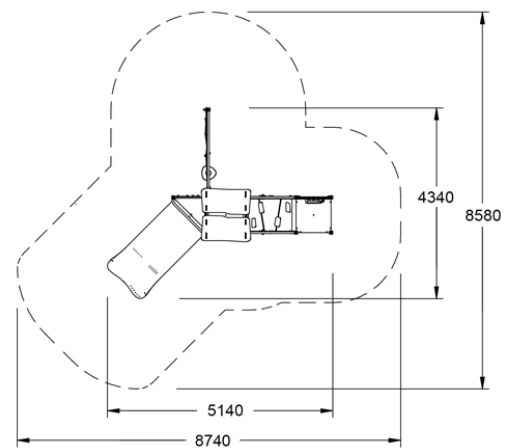

## SIDE ELEVATION

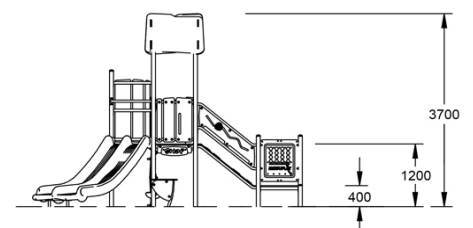

[WARRANTY](#)



[CARE PLAN](#)



[COMPLIANCE](#)



[AUS MADE](#)