

30 SERIES

G-1311
Cob



PRODUCT INFORMATION



[Download Files](#)



[Colour Scheme](#)



[3D Render](#)



SUITABLE FOR EXTREME MARINE



[Extreme Marine](#)

PLAY VALUE



CLIMB



SLIDE



STRENGTH



SOCIAL PLAY



x 6
ACTIVITIES



x 8
USERS

SPECIFICATIONS

| | |
|---------------------------|---------------------|
| Age Range | Junior / Mixed |
| Fall Height | 1200mm |
| Soft-fall Area | 29.3 m ² |
| Space Req. Incl Soft-fall | 7.8m x 4.7m |

TECHNICAL INFORMATION

| | |
|--------------------------|--------------------|
| AUS Standards Compliance | AS4685 |
| Assembly Time | 5 hours |
| Total Weight | 435 kg |
| Heaviest Component | 68 kg |
| Concrete Required | 1.6 m ³ |
| Number of Footings | 9 |

TOP VIEW

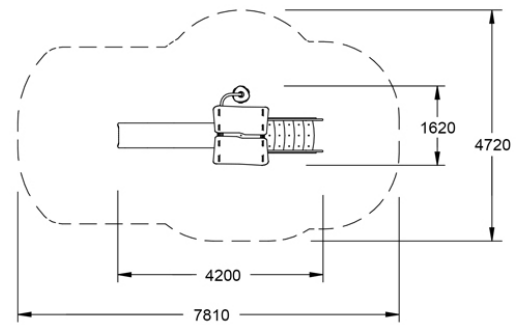

SIDE ELEVATION

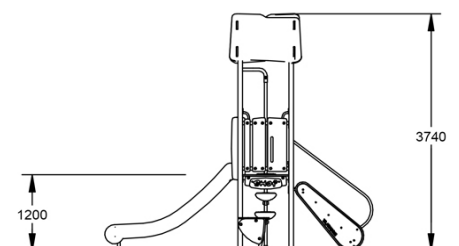

[WARRANTY](#)



[CARE PLAN](#)



[COMPLIANCE](#)



[AUS MADE](#)