

# 30 SERIES

**G-1301**  
Papilo

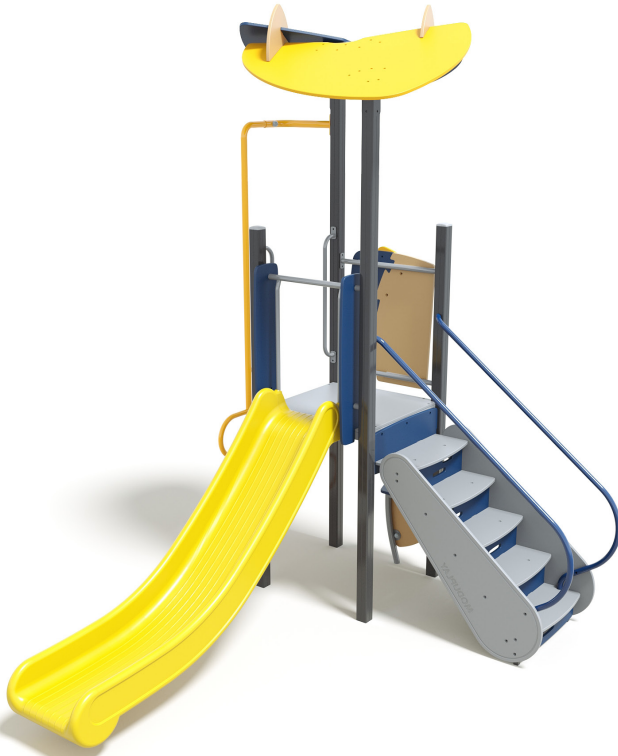

## PRODUCT INFORMATION



[Download Files](#)



[Colour Scheme](#)



[3D Render](#)



SUITABLE FOR EXTREME MARINE



[Extreme Marine](#)

## PLAY VALUE



CLIMB



SOCIAL PLAY



STRENGTH



SLIDE



x 6  
ACTIVITIES



x 7  
USERS

## SPECIFICATIONS

Age Range	Junior / Mixed
Fall Height	1200mm
Soft-fall Area	29.3 m <sup>2</sup>
Space Req. Incl Soft-fall	6.6m x 5.7m

## TECHNICAL INFORMATION

AUS Standards Compliance	AS4685
Assembly Time	5 hours
Total Weight	335 kg
Heaviest Component	68 kg
Concrete Required	1.6 m <sup>3</sup>
Number of Footings	9

## TOP VIEW

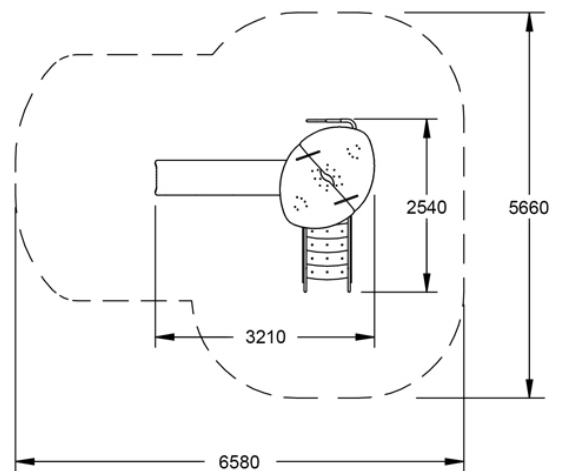

## SIDE ELEVATION

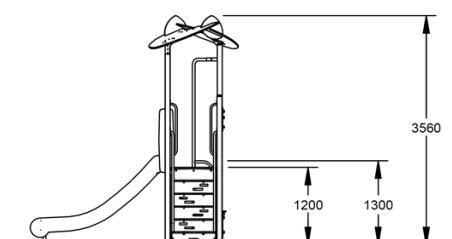

[WARRANTY](#)



[CARE PLAN](#)



[COMPLIANCE](#)



[AUS MADE](#)