

PRODUCT INFORMATION

 [Download Files](#)

 [3D Render](#)

 SUITABLE FOR EXTREME MARINE

 [Extreme Marine](#)

PLAY VALUE



 x 3
ACTIVITIES

 x 5
USERS

SPECIFICATIONS

Age Range	Mixed / Adult
Fall Height	3430mm
Soft-fall Area	23.50m ²
Space Req. Incl Soft-fall	4.90m x 5.50m

TECHNICAL INFORMATION

AUS Standards Compliance	AS4685
Install Time (Team of 2)	6 hrs
Total Weight	90 kg
Heaviest Component	30 kg
Concrete Required	.30 m ³
Number of Footings	6

TOP VIEW

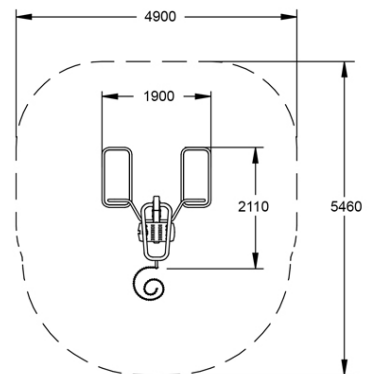

SIDE ELEVATION

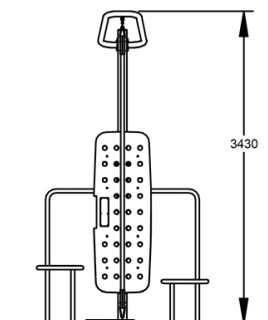

[WARRANTY](#)



[CARE PLAN](#)



[COMPLIANCE](#)



[AUS MADE](#)